

GASOLINE LOG SPLITTER



Owner's Manual and Operation Instructions

⚠ OPERATION INSTRUCTIONS

Proper Operation of the Log Splitter as per instruction labels on machine

- 1.) Load a log onto the splitter and against the wedge.
- 2.) Serious accidents can happen when other people are allowed inside the work zone. Keep everyone else out of the work zone while operating control valve.
- 3.) Make sure hands are clear of crush hazard zones.
- 4.) **Push control valve handle to bottom position(FIRST SPLIT) to split logs. When wedge into log, put the handle in middle position(SECOND SPLIT) to fast split log fully.**
- 5.) Release control valve handle by two hands to return pusher to its original position.
- 6.) Clear the split wood from the work zone.

Important: Before starting log splitter, Bleed screw should be loosened by a few turns to make sure the air circulation

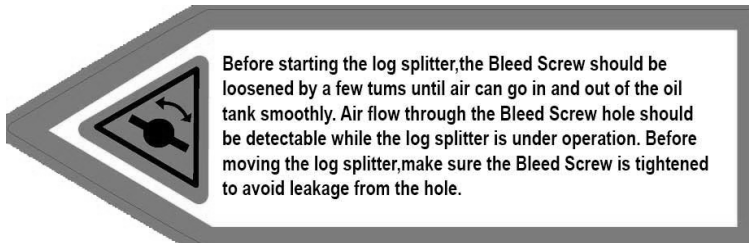

How to split log with slant surface

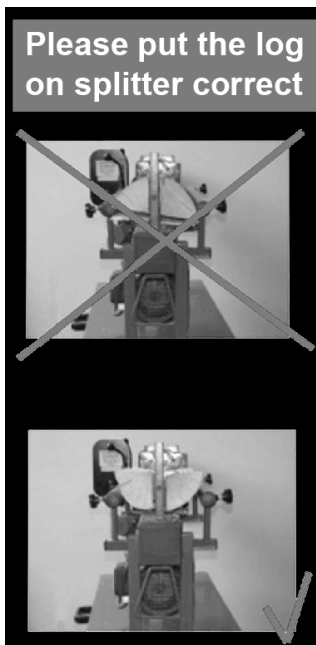

How to use the two speeds

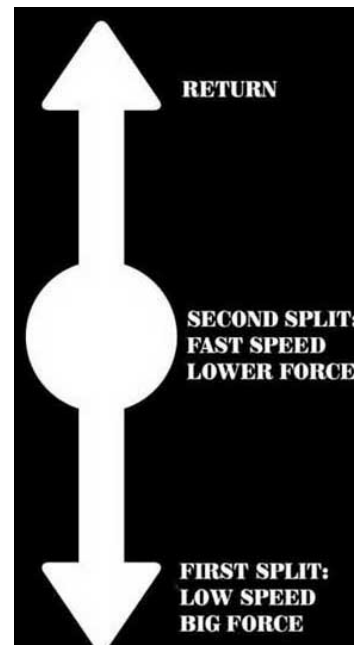

Important: Please don't push the handle exceed 5seconds each time if the log is hard to split, release handle and try again.

OPERATION INSTRUCTIONS

FOR SPLITTING

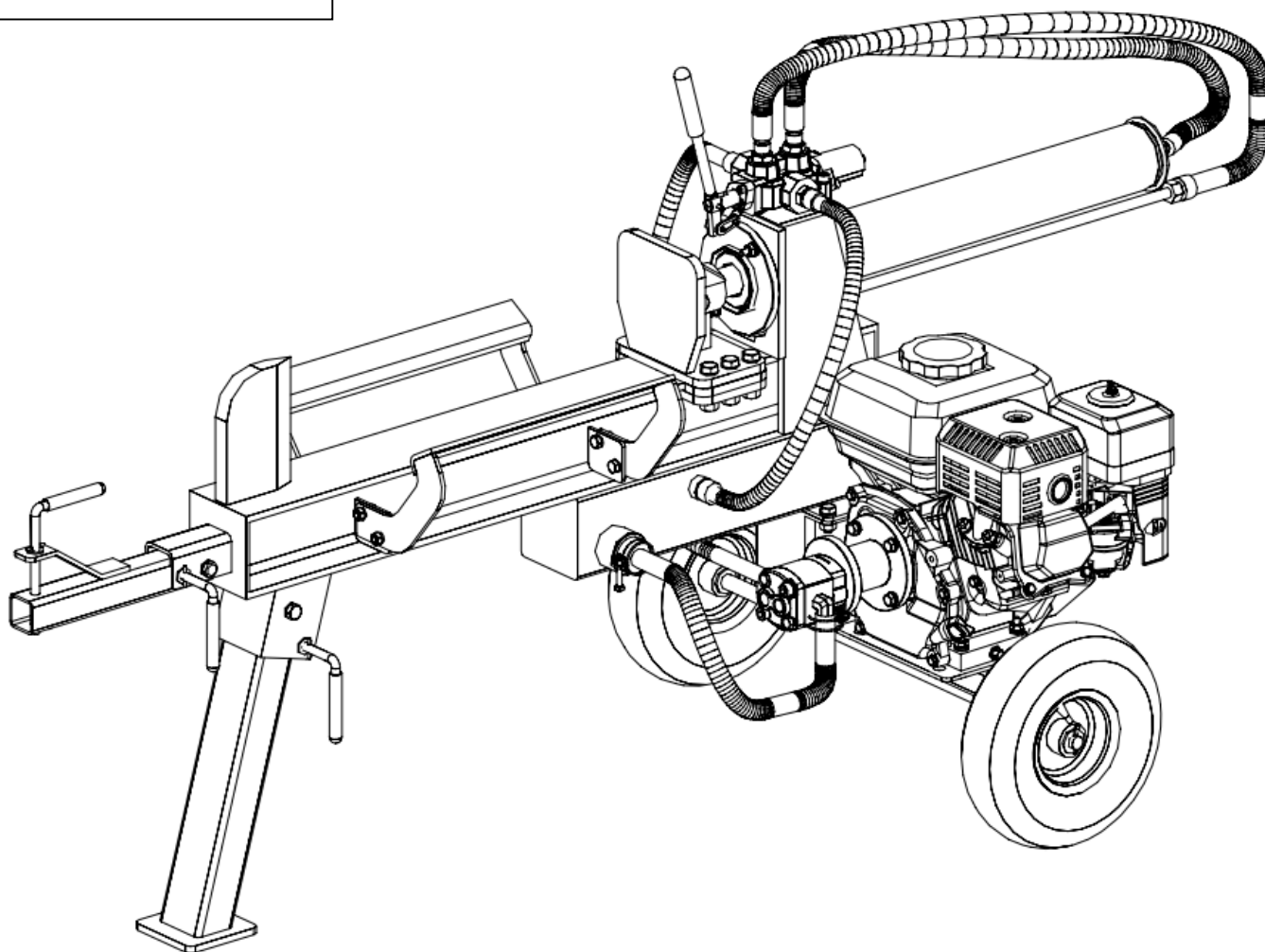

FOR TOWING

⚠ MAINTENANCE AND STORAGE

Before performing maintenance, the log splitter must be placed in maintenance mode.



- 1.) Turn off engine.
- 2.) Release the control valve handle to relieve hydraulic pressure.



After performing maintenance, make sure all guards, shields, and safety features are put back in place. Failure to follow this warning can result in serious injury.

Refer to the engine owner's manual for engine maintenance.

What	When	How
Hoses	Each Use	Inspect for exposed wire mesh and leaks. Replace all worn or damaged hoses before starting engine
Hydraulic Fittings	Each Use	Inspect for cracks and leaks. Replace all damaged fittings before starting engine
Nuts and Bolts	Each Use	Check for loose bolts
Rail plate	Each Use	Apply grease to rail plate surface
Moving Parts	Each Use	Clear debris

SPECIFICATIONS

Maximum Flow	2.5GPM
Hydraulic Fluid Capacity	5Liter
Hydraulic Fluid Type	10wt AW32, ASLE H-150, or ISO32
Maximum Towing Speed.....	10MPH
Maximum Log Length	20"
Hydraulic Cylinder Bore	3"
Hydraulic Cylinder Stroke	19"
Maximum Log Diameter	14"

TROUBLESHOOTING

Problem	
Cylinder rod will not move	SOLUTION: A,D,E,H,J
Slow cylinder rod speed when extending or retracting	SOLUTION: A,B,C,H,I,K,L
Wood will not split or splits extremely slowly	SOLUTION: A,B,C,F,I,K
Engine bogs down during splitting	SOLUTION: G,L
Engine stalls under low load condition	SOLUTION: D,E,L,M
Cause	Solution
A -Insufficient oil to pump	Check oil level in reservoir
B -Air in oil	Check oil level in reservoir
C -Excessive pump inlet vacuum	Check pump inlet hose for blockage or kinks
D -Blocked hydraulic lines	Flush and clean the splitter hydraulic system
E -Blocked control valve	Flush and clean the splitter hydraulic system
F -Low control valve setting	Adjust control valve with a pressure gauge
G -High control valve setting	Adjust control valve with a pressure gauge
H -Damaged control valve	Return control valve for authorized repair
I -Internal control valve leak	Return control valve for authorized repair
J -Internal cylinder leak	Return cylinder for authorized repair
K -Internally damaged cylinder	Return cylinder for authorized repair
L -Engine Control out of adjustment	Adjust idle control nuts
M -Engine is loaded during idle down mode	Use shorter log length to allow engine to speed up before contact.

ASSEMBLY

Open Shipping Box

1. Set the shipping Box on a solid, flat surface.
2. Carefully open the shipping box and take out the separate parts from the box make sure all parts included refer to the page COMPONENTS IN THE PACKAGE
3. Locate all hardware before beginning assembly.

Step 1: Attach Hydraulic Pipe

Put the Hydraulic Pipe on the body fix by Hex Bolt M8X40, Flat washer $\phi 8$, Spring washer M8 and M8 Nut

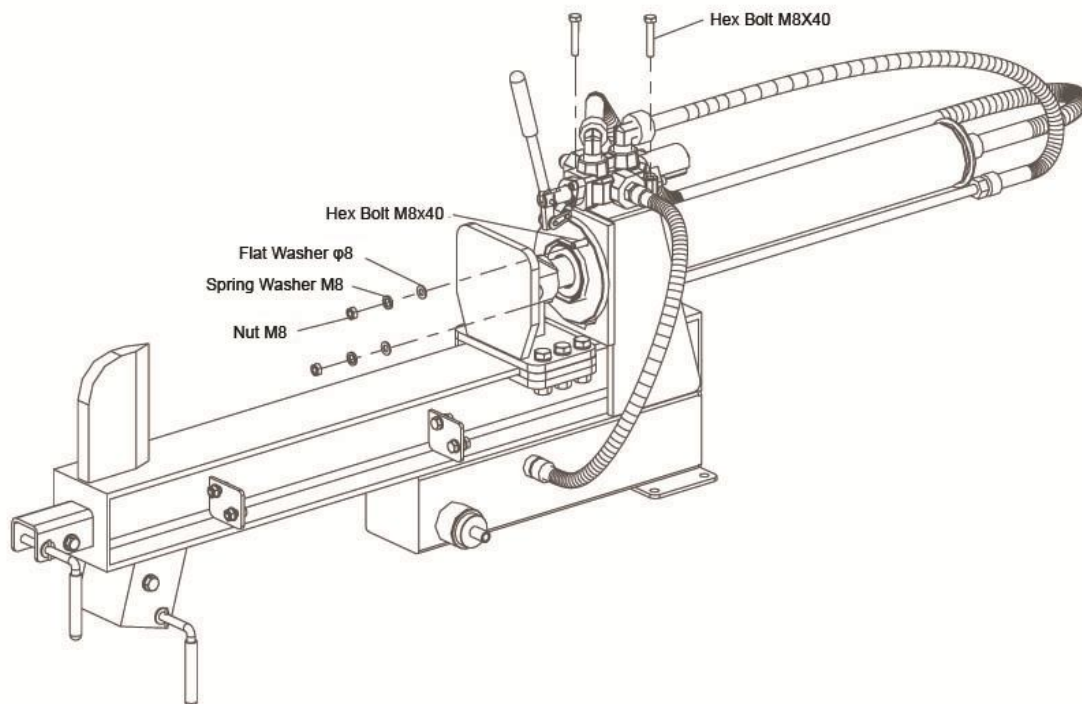

Step 2: Attach wheel and hinge on body

Attach the both outrigger on body fix by flat washer $\phi 10$, Hex Bolts M10X100, R pin, Pin and M10 Nut.

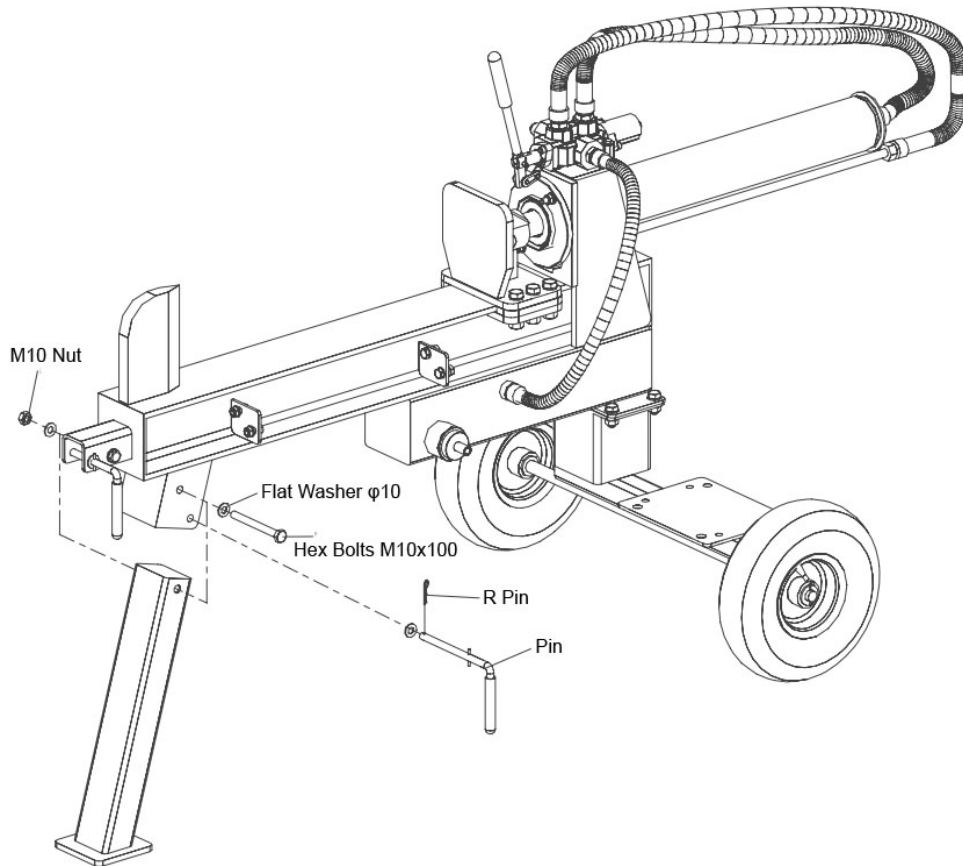

Step 3: Attach outrigger on body

Put the wheels to the axle fix by a Flat Washer $\phi 16$ in both side of wheel, fix with R Pin.
Put body on plate on wheel, fix by hex bolt M10x25, flat washer $\phi 10$ and hex nut M10.

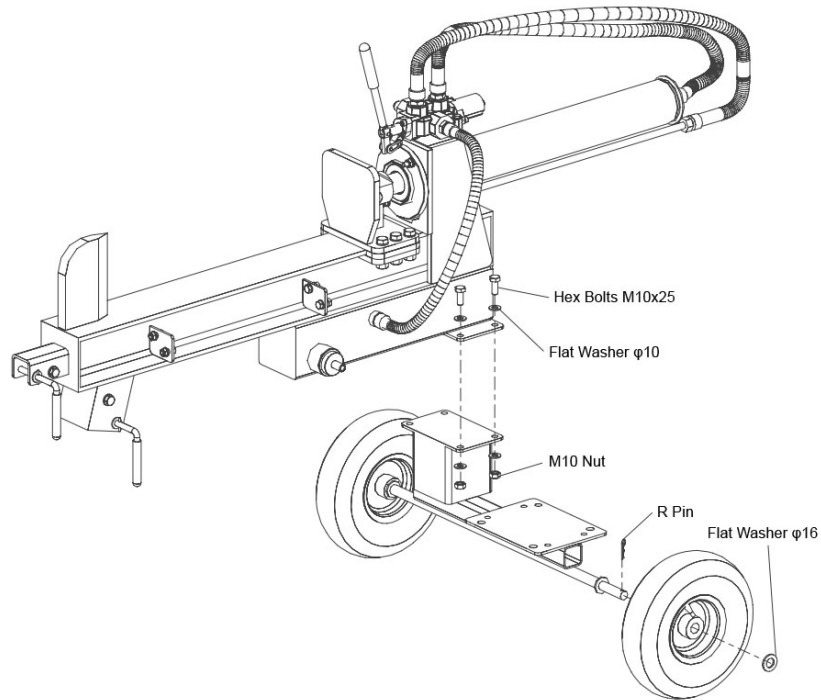

Step 4: Attach engine and hose

Put the engine on the plate and shock pad under engine, fix by M8 Nut, Spring Washer M8, Flat Washer $\phi 8$, Hex Bolts M8x45.

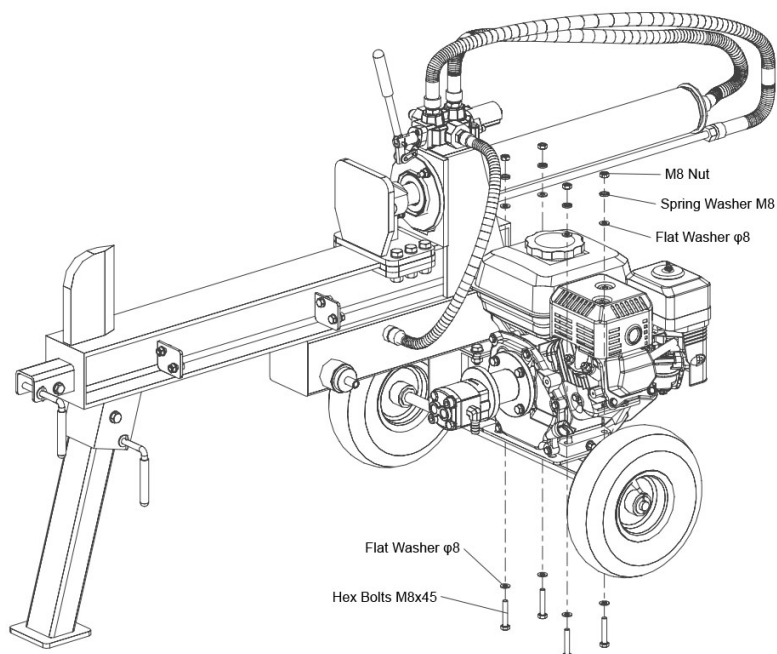

Step 5: Assemble the Suction Hose

Assemble the Suction Hose by Hoops.

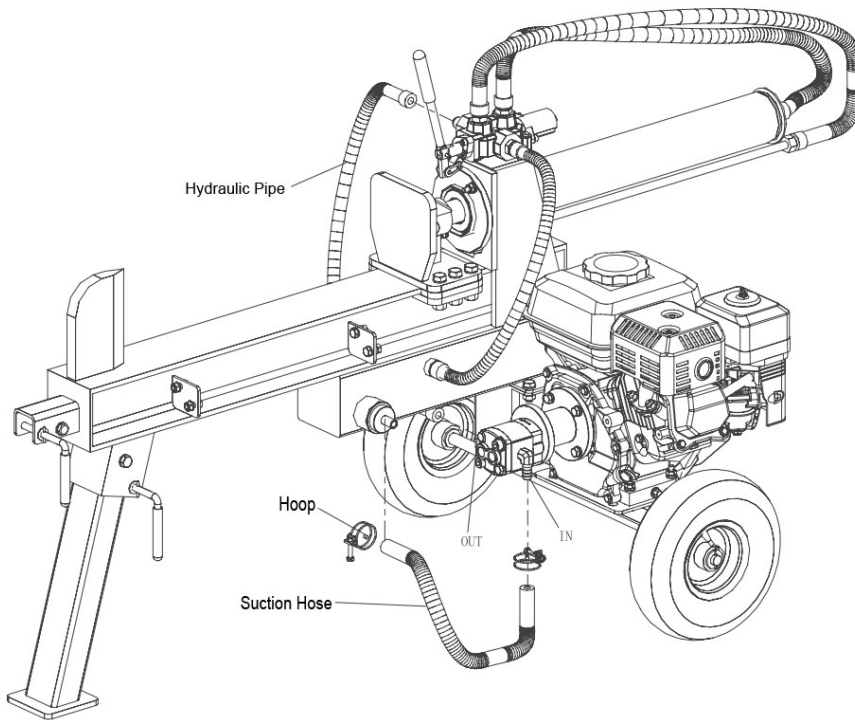

Step 6: Assemble Log cradle and Handle

Assemble Log cradle by Flat Washer $\phi 8$, M8 Nut and Hex Bolts M8x25.

Assemble Handle by M10 Nut, Flat Washer $\phi 10$, R Pin, Pin and Hex Bolt M10x70.

