

Product Service Manual

Model: Corn Thresher Series (Please read the product service manual carefully before use)

Safety Precautions:

Please check the machine before the first use.

- 1 . Whether the triangle belt is too loose or too tight; the triangle belt should be kept parallel and perpendicular;
- 2 . Whether each assembly bolts are fastened;
- 3 . Whether the motor is installed in parallel;
- 4 . Whether the rotation direction of the motor and machine is correct;
- 5 . The power cord shall not be damaged;
- 6 . The protective cover shall be well assembled;
- 7 . After checked the completion of 1-6 precautions, turn the power supply on to make the machine running idly for 1-2 minutes.

Notices During Use:

- 1 . Prohibit the minors and the elderly from operating the machine;
- 2 . Prohibit the handicapped from operating the machine;
- 3 . Do NOT operate the machine after drinking;
- 4 . Make the machine running idly for inspection before each use;
- 5 . Do NOT feed agricultural materials before starting the machine;
- 6 . Do NOT remove the protective cover when operating the machine;
- 7 . If abnormal noise is detected, turn off the power immediately, pull out the plug and then inspect the machine;
- 8 . No metal or the hard stuff can be mixed in the agricultural materials (if metal or the hard stuff entered the machine, turn off the power in time for cleaning);
- 9 . If the machine breaks down, metal or the hard stuff enters the machine, stop the machine and clear fault. Rotate the machine by hand to check whether the machine is normal and whether each component is damaged. The test of running machine idly must be implemented to ensure that no damage to each component and the machine is intact before starting the power supply and pouring in the agricultural materials. (The operator is not allowed too near the machine when starting the power.

The machine can continue to operate after normal running idly);

10 . Use of Electric Motors:

① The connection of the motor shall implement a reliable installation of the ground wire (if the machine is equipped with a disconnection switch, the ground line of the incoming line shall be installed on the machine, and the reliable installation of the ground wire is a solid protection for the operator if the electricity is leaked from motor in an accident);

② The motor has the overheating protection function, overload or voltage instability will cause the motor overheating;

③ Overheating motor will automatically stop to protect the motor;

④ Turn off the power supply immediately when the motor stop to work, and clear the materials left in the machine. (If the power supply is not turned off, the motor will start automatically after the temperature drops, and causing damage to the machine or security incidents, so turn off the power in time after the automatic shutdown);

⑤ After the motor stops to work, clear the remaining materials, and start the power supply for operation after the motor is steady and motor temperature drops;

⑥ If the motor is shut down frequently due to overheating, check whether the voltage is too low or whether the incoming line is too thin or too long. If the incoming line is too thin and too long, it needs to re-install;

⑦ Motor capacitors are divided into starting capacitors and working capacitors. If the capacitors are damaged, please be sure to distinguish capacitor types during installation. The wrong connection will lead to the motor buzz and cannot start;

⑧ Altering the method of incoming wire connection at the motor can avoid the motor overheat protector mechanism, but it is strongly recommended not to use this scheme, which may cause the motor to burn out because of the high temperature of the motor caused by the overloading or the voltage instability.

Notice for warning and label:

① Do not remove warning labels;

② Please operate strictly in accordance with the warning label requirements:

Warning Label 1:



Warning Label 2:



Warning Label 3:



Rotation Direction 5:



Conditions for the use of machines:

- 1 . The machine should be placed in a dry, bright and ventilated environment;
- 2 . The machine is not allowed to be wet state, especially the motor is not allowed to have any wet state;
- 3 . If the user does not purchase our company's magnet, the user shall buy and install it by himself. The magnet should be installed at the entrance of the feeding hopper to avoid metal and the hard stuff from entering the machine chamber.
- 4 . It is forbidden for machines to process iron filings, coal, wood, stones, and other hard objects.

Product structure and parameters:

1 . Complete Machine Structure

5YT-60-90 Corn Thresher Structure Layout

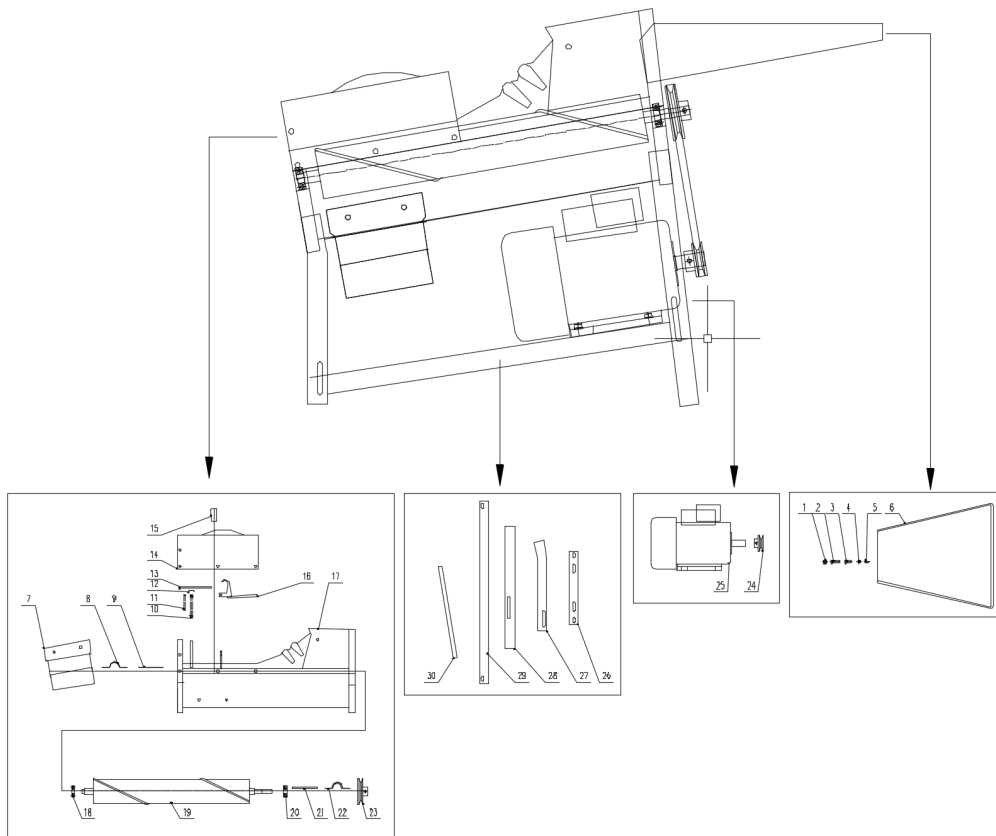

2 . Parts Decomposition Chart

Corn Thresher Machine Parts	
30	Triangle Belt
29	Reverse Bar
28	Long Column
27	Short Column
26	Motor Bar
25	Motor
24	Motor Wheel
23	Pulley
22	Bearing Gland
21	Bearing Plate
20	Bearing
19	Roller
18	Bearing
17	Machine Body
16	Shift Lever
15	Shift Handle
14	Shift Cover
13	Voltage Regulation Board
12	Spring Press Board
11	Short Spring
10	Long Spring
9	Bearing Plate
8	Bearing Gland
7	Discharge Hopper
6	Feed Hopper
5	Hexagon Bolt M6X12
4	Hexagonal Nut M6
3	Hexagon Bolt M8X16
2	Hexagon Bolt M8X25
1	Hexagonal Nut M8

3 . Main Technical Parameters

5TY-60-90 Corn Thresher			
Power:	2.0 HP	Frequency:	50/60 HZ
Voltage:	220 V	Weight:	37 kg
Productivity: 600-800 kg/h			

The quick-wear parts of the machine:

1. V-Belt

Machine maintenance:

- ① After the machine runs for a while, the position with the oil injection hole should be filled with lubricating oil;
 - ② The quick-wear parts of the machine should be checked regularly for wear. The quick-wear parts should be replaced if they are seriously worn (excessive wear will affect the machine effect).
 - ③ Check the tension of the triangle belt regularly.
-

After-Sales Service Information:

1.After-sales guidance

- This after-sales service information shall be filled out by the distributor.
- The customer presents this document as a certificate of after-sales service.
- Quick-wear parts are purchased by users themselves.
- Damage caused by man-made or improper operation shall be paid for service.
- If the service term is exceeded, the service shall be paid.

2.Distributor

Company Name:_____

Contact Information:_____

Address:_____

Email address:_____

3.Product Information

Product Signal:_____

Product Name:_____

Product No.:_____

Purchase Time:_____

Term of Service:_____

- ④ Please save this customer service information.