

SPRAYERS

PM100 Model
PM200 Model



USER MANUAL



Before using machine, surely read this manual



Before using machine, surely read this manual

USER MANUAL

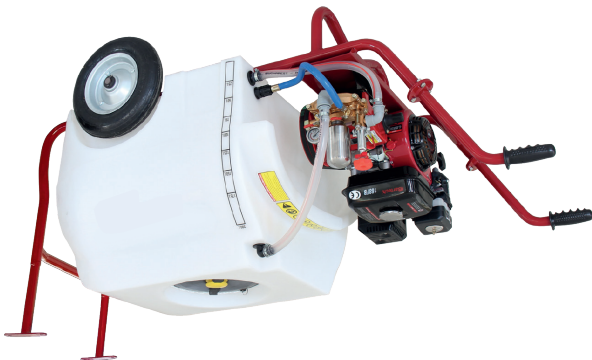

PM100 Model
PM200 Model

SPRAYERS



*** KEEP CHILDREN AWAY WHEN MACHINE IS RUNNING !**

- 03 Safety Signs & Symbols
- 04 Safety Instructions
- 05 Before Starting Sprayer
- 06 Things To Do Crop Processing & Ending
- 06 Pump & Engine motor oil change
- 06 Maintenance
- 07 Malfunction and Maintenance Instructions
- 07 After Spraying
- 08 Sprayer Pm200 ve Technical Specifications
- 09 Pump Using
- 10 Pump Defination
- 13 Diagram Of The Sprayer Pump
- 15 Using Gasoline Engine
- 16 Gasoline Engine Technical Specifications
- 17 How start gasoline engine

61

CONTROLS	ENGINE OIL	Level check	X			
	Replace			X		
	AIR FILTER	Control	X			
	Oil Filter	Cleaning				
FUEL FILTER	Check + adjust					
	FUEL TANK AND					
	GAPS OR VALVES					
EVERY YEAR OR IN 300 HOURS	EVERY 6 MONTHS OR IN 100 HOURS	EVERY 3 MONTHS OR IN 50 HOURS				
BEFORE USING IN 20 HOURS						
X						
X						

STANDARD FEATURES

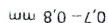

- * Powerful and technologic
- * four stroke, air cooled
- * direct injection, silence working
- * easy starting and maintenance (with rope)
- * its proper to easy transport, small and light.

SAFETY INSTRUCTIONS

- * Place the fuel cock to "ON" position and remove the filter cover.
- * Clean inside of box.
- * Pay attention that fuel filter can not be dirty or watery, replace it if dirty.
- * While disassemble and assemble , do not damage to O-RING, replace it if it is deformed.

FUEL FILTER MAINTENANCE

- * Place the fuel cock to " ON" position and remove the filter cover.
- * Clean inside of box.
- * Pay attention that fuel filter can not be dirty or watery, replace it if dirty.
- * While disassemble and assemble , do not damage to O-RING, replace it if it is deformationed.

SPARK PLUG MAINTENANCE

- * Check the spark plug by your eye, please clean the dirt and soots with wire brush.
If there is break or split on insulator, throw it out.
- * Measure the electrode gap of spark plug by feeler gauge. Gap must be between 0,7-0,8 mm
- * Assemble the spark plug to its place after cleaned with tight. Do not leave the spark plug loose, it gets hot and causes damage to engine.

- * Powerful and technologic
- * four stroke, air cooled
- * direct injection, slience working
- * easy starting and maintenance (with rope)
- * its proper to easy transport, small and light.

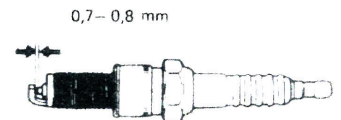

CONTROLS		BEFORE USING	FIRST MONTH OR IN 20 HOURS	EVERY 3 MONTHS OR IN 50 HOURS	EVERY 6 MONTHS OR IN 100 HOURS	EVERY YEAR OR IN 300 HOURS
ENGINE OIL	Level check	X				
	Replace		X		X	
OIL FILTER	Replace					X
AIR FILTER	Control	X				
	Cleaning			X		
FUEL FILTER	Cleaning				X	
GAPS OF VALVES	Check + adjust					X
FUEL TANK AND FUTER	Cleaning					X

20

17	How start gasoline engine
16	Gasoline Engine Technical Specifications
15	Using Gasoline Engine
13	Diagram Of The Sprayer Pump
10	Pump Definition
09	Pump Using
08	Sprayer Pm200 ve Technical Specifications
07	After Spraying
07	Malfunction and Maintenance Instructions
06	Maintenance
06	Pump & Engine motor oil change
06	Things To Do Crop Processing & Ending
05	Before Starting Sprayer
04	Safety Instructions
03	Safety Signs & Symbols

CONTENT



CAUTION !

* REED USED MANUAL BEFORE USING !
* KEEP CHILDREN AWAY WHEN MACHINE IS RUNNING !

TROUBLES

ENGINE DOESNT WORK OR ITS STOPPING WHILE WORKING

- * Check the oil level, add oil if needed
- * is there any air in fuel system ? If have, take it out.
- * Check the fuel tank, fill fuel if needed.
- * Check the fuel cock open or not.

MAINTENANCE

- * Purpose of maintenance is to ensure of motopump works in best condition.
- * Stop the engine during maintenance operation. Do mainteance often in dusty areas.

OIL CHANGING

- * Do draining of oil operation while engine is hot
- * Remove oil drain plug and oil filling plug.
- * After drained oil, reassemle the plugs to their places tightly
- * Fill the oil till oil filling sign .
- * Do not dirtying the environment while changing the oil. Ensure the cleaning of outgoing oils properly. clean your hand plenty of water and soap.

AIR FILTER MAINTENANCE

- * Dirty air filter prevents the carburator's working properly and efficiently by preventing air flow to carburator.
Please do air filter maintenance ofter in dusty and dirty areas.
- * Remove the air filter cover, take out sponge filter element.
- * Replace torn or punched parts.
- * Replace the paper filter element in case of torn or very dirty.
- * Clean the filter seat and air passing pipe.
- * After washed the sponge element in detergent water by plenty of water, DRY it. Dip it into clean oil and take out excess oil by squeezing. After operation finished, reassemble the sponge element its place by closing the cover and tight the screw.

18

03

SAFETY SIGNS & SYMBOLS



READ USER MANUAL BEFORE USING !

CAUTION !

BEFORE RUNNING

Engine : 650 ml - No.10/40

Pump : 650 ml - No.30

FILL OIL !

CAUTION !

DO NOT GET INTO !

YOUR HAND TO MOVING PARTS

KEEP YOUR MACHINE

FROM RISK OF FREEZING

CAUTION !

Do not use flammable and inflammable fluid with pulverizators.

For cleaning and maintenance you should wait for the motor stop first.

Do not dispose of waste produced by the machine directly in the trash. Handle depending on your countries enuironmetal regulations.

HOT

SURFACE

CAUTION !

DO NOT SPRAY CHEMICALS TO THE LIVINGS.

Despite the chemicals are corrosive and toxic, you should use protection masks, glasses and gloves.

03

18

- * Dirty air filter prevents the carburator's working properly and efficiently by preventing air flow to carburator.
- * Please do air filter maintenance ofter in dusty and dirty areas.
- * Remove the air filter cover, take out sponge filter element.
- * Replace torn or punched parts.
- * Replace the paper filter element in case of torn or very dirty.
- * Clean the filter seat and air passing pipe.
- * After washed the sponge element in detergent water by plenty of water, DRY it. Dip it into clean oil and take out excess oil by squeezing. After operation finished, reassemble the sponge element its place by closing the cover and tight the screw.

AIR FILTER MAINTENANCE

- * Do draining of oil operation while engine is hot
- * Remove oil drain plug and oil filling plug.
- * After drained oil, reassemble the plugs to their places tightly
- * Fill the oil till oil filling sign .
- * Do not dirtying the environment while changing the oil. Ensure the cleaning of outgoing oils properly. clean your hand plenty of water and soap.

OIL CHANGING

- * Purpose of maintenance is to ensure of motopump works in best condition.
- * Stop the engine during maintenance operation. Do maintenance often in dusty areas.

MAINTENANCE

- * Check the oil level, add oil if needed
- * is there any air in fuel system ? If have, take it out.
- * Check the fuel tank, fill fuel if needed.
- * Check the fuel cock open or not.

ENGINE DOESNT WORK OR ITS STOPPING WHILE WORKING

TROUBLES

SAFETY SIGNS & SYMBOLS



READ USER MANUAL BEFORE USING !

CAUTION !

BEFORE RUNNING

Engine : 650 ml - No.10/40

Pump : 650 ml - No.30

FILL OIL !

KEEP YOUR MACHINE

FROM RISK OF FREEZING

For cleaning and maintenance you should wait for the motor stop first.

HOT

SURFACE

CAUTION !

DO NOT SPRAY CHEMICALS TO THE LIVINGS.

Do not dispose of waste produced by the machine directly in the trash. Handle depending on your countries enuironmetal regulations.

SAFETY INSTRUCTIONS

- In case of any malfunction or suspected negative operation, do not interfere during working/operating. Firstly let your machine stop and then intervene.
- For safety reasons; Keep children away from the machine when the machine is in operation or not.
- During working with the machine; Wear your protective clothing, safety goggles and mask.

CAUTION !

- At the end of daily operations, stop your machine completely and take necessary measures, then clean regularly. This is important both for hygiene and also to extend the lifetime of your machine.
- Never wash your machine, clean it with a damp cloth or sponge.
- Store your machine in a dry and clean place.
- Contact your authorized technical service in case of any malfunction in your machine.

DESCRIPTION OF MACHINE WORKING PRINCIPLE

the pump with three pistons that taking movement from thermal engine by belt pulley, pushing the liquid to spraying control group which has been absorbed from chemical tank. the liquid that adjusted of pressure in here is forwarded to the sprayer gun via hose.pulverization process is being done by sprayer gun which has adjustable spayer head.

04

17



* turn off the FUEL COCK.

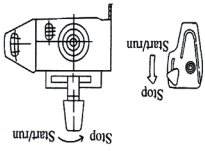

* Place the engine open close lever to " STOP" position

STOPPING

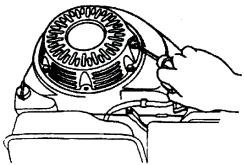

4. Pull the rope till you feel resistance, and release it slowly. Grab the ROPE HOLDER properly and pull by forced and release it. Place the choke rod to " START/RUN" position. If you dont start it up , please try again.



3. Place choke rod to " CHOKE" position.

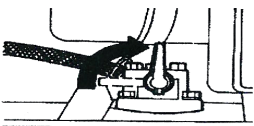

2- Place the fuel cock to " ON " position. If there is air inside of fuel hose, take it out. Drain the fuel till there will be not any air bubble inside fuel. When there is no air bubble, reassemble the hose to its place and tight.

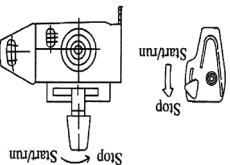

STARTING ON THE ENGINES WITH ROPES

1-Place the open -close switch to " START" position.

STARTING

STARTING

STARTING ON THE ENGINES WITH ROPES

1-Place the open -close switch to " START" position.

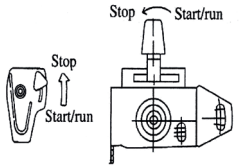

2- Place the fuel cock to " ON " position. If there is air inside of fuel hose, take it out. Drain the fuel till there will be not any air bubble inside fuel. When there is no air bubble, reassemble the hose to its place and tight.

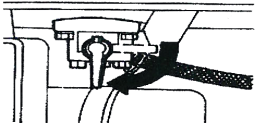

3. Place choke rod to " CHOKE" position.



4. Pull the rope till you feel resistance, and release it slowly. Grab the ROPE HOLDER properly and pull by forced and release it. Place the choke rod to " START/RUN" position. If you dont start it up , please try again.

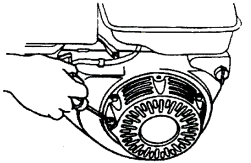

STOPPING

* Place the engine open close lever to " STOP" position

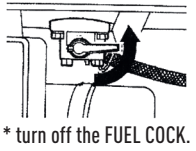
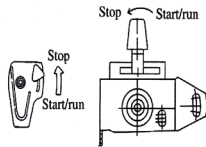

* turn off the FUEL COCK.

17

04

the pump with three pistons that taking movement from thermal engine by belt pulley, pushing the liquid to spraying control group which has been absorbed from chemical tank. the liquid that adjusted of pressure in here is forwarded to the sprayer gun via hose.pulverization process is being done by sprayer gun which has adjustable spayer head.

DESCRIPTION OF MACHINE WORKING PRINCIPLE

- At the end of daily operations, stop your machine completely and take necessary measures, then clean regularly. This is important both for hygiene and also to extend the lifetime of your machine.
- Never wash your machine, clean it with a damp cloth or sponge.
- Store your machine in a dry and clean place.
- Contact your authorized technical service in case of any malfunction in your machine.

CAUTION !

- In case of any malfunction or suspected negative operation, do not interfere during working/operating. Firstly let your machine stop and then intervene.
- For safety reasons; Keep children away from the machine when the machine is in operation or not.
- During working with the machine; Wear your protective clothing, safety goggles and mask.

SAFETY INSTRUCTIONS

SAFETY INSTRUCTIONS

GENERAL SAFETY INSTRUCTIONS

BEFORE STARTING

* CHECK THE OIL LEVEL !

Engine delivered without oil. Please fill the oil before using.if there is no oil inside engine or oil level less in that time OIL LAMP shines, if motor is working, it stops.Oil must be filled till the minimum oil level sign of the engine.The engine oil effects engine's lifetime and its performance.

Please use four stroke and high quality oil.
Do not use herbal and dirty oil.Plese wait about 3 minutes after you filled the oil and before start the engine.
The low oil level automatic closing fitting engages and it will prepare itself to starting.

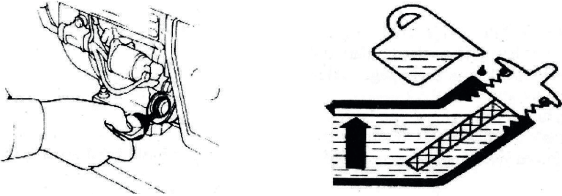

* CHECK THE FUEL LEVEL !

Stop the engine while filling FUEL. Do not use FUEL which is dirty and if you are not sure quality of it. Never add oil to fuel. Fuel is extremely flameable and explosive, never smoke during filling operation.

Do not filling at the areas which has flameable and sparky.
Fill the fuel to the tank by using BIN with filling hose or nozzle and do not overflow from the tank There must not be any fuel around tank cover. After filling operation, tank cover must be closed tightly.
if there is any poured fuel, please clean it.

* CHECK THE AIR FILTER !

Never work the WATER PUMP without air filter. Check the air filter components, make sure that all are clean and good condition. If filter torn or very dirty, please replace it.

16

05

ATTENTION: WHILE MAKING PRESSURE ADJUSTMENT , IT MUST BE DONE DEFINETELY THE INDICATOR SHOULD BE ADJUSTED AS NOT TO OVER THAN 40 BAR (YELLOW AREA). OTHERWISE IT CAUSE TO OCCUR PUMP MALFUNCTION

While starting to spraying process, by opening chemical valve to start application.
Meanwhile, pressure is adjusted by the pressure adjustment valve which is on the regulator in order make the mixture get reach to requested pressure.

SPRAYING PROCESS

CAUTION ! : IN ORDER TO PREVENT MACHINE'S RISING TO EXTREME HIGH RPM, PLEASE FOLLOW THE PRESSURE FROM PRESSURE GAUGE.

NOTE : MIXER VALVE CAN BE LET OPEN CONTINUOUSLY DURING APPLICATION, THERE IS NO PROBLEM FOR THE MACHINE

Depending on the process to be done the chemical tank cover of the tank with full with chemical or existed full water is opened and discharge to inside than closed.
By getting the mixer valve which on the pump takes to open position to make movement to pump, thus, the mixture of water with chemical is provided.
Duration of the mixture completion can be change depending on type of used chemicals

BEFORE STARTING SPRAYER

BEFORE STARTING SPRAYER

Depending on the process to be done the chemical tank cover of the tank with full with chemical or existed full water is opened and discharge to inside than closed.

By getting the mixer valve which on the pump takes to open position to make movement to pump. thus, the mixture of water with chemical is provided.

Duration of the mixture completion can be change depending on type of used chemicals

CAUTION ! : IN ORDER TO PREVENT MACHINE'S RISING TO EXTREME HIGH RPM, PLEASE FOLLOW THE PRESSURE FROM PRESSURE GAUGE.

NOTE : MIXER VALVE CAN BE LET OPEN CONTINUOUSLY DURING APPLICATION, THERE IS NO PROBLEM FOR THE MACHINE

SPRAYING PROCESS

While starting to spraying process, by opening chemical valve to start application.

Meanwhile, pressure is adjusted by the pressure adjustment valve which is on the regulator in order make the mixture get reach to requested pressure.

ATTENTION: WHILE MAKING PRESSURE ADJUSTMENT , IT MUST BE DONE DEFINETELY THE INDICATOR SHOULD BE ADJUSTED AS NOT TO OVER THAN 40 BAR (YELLOW AREA). OTHERWISE IT CAUSE TO OCCUR PUMP MALFUNCTION

05

16

Never work the WATER PUMP without air filter. Check the air filter components, make sure that all are clean and good condition. If filter torn or very dirty, please replace it.

* CHECK THE AIR FILTER !

Stop the engine while filling FUEL. Do not use FUEL which is dirty and if you are not sure quality of it. Never add oil to fuel. Fuel is extremely flameable and explosive, never smoke during filling operation.
Do not filling at the areas which has flameable and sparky.
Fill the fuel to the tank by using BIN with filling hose or nozzle and do not overflow from the tank There must not be any fuel around tank cover. After filling operation, tank cover must be closed tightly.
if there is any poured fuel, please clean it.

* CHECK THE FUEL LEVEL !

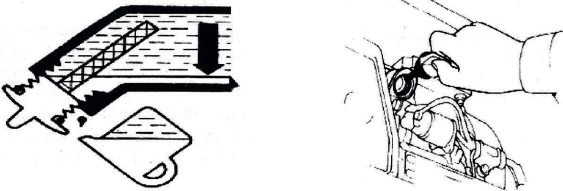

The low oil level automatic closing fitting engages and it will prepare itself to starting.
start the engine.
Do not use herbal and dirty oil.Plese wait about 3 minutes after you filled the oil and before Please use four stroke and high quality oil.

minimum oil level sign of the engine.The engine oil effects engine's lifetime and its performance.
oil level less in that time OIL LAMP shines, if motor is working, it stops.Oil must be filled till the Engine delivered without oil. Please fill the oil before using.if there is no oil inside engine or

BEFORE STARTING

* CHECK THE OIL LEVEL !

GENERAL SAFETY INSTRUCTIONS

SAFETY INSTRUCTIONS

THINGS TO DO CROP PROCESSING & ENDING

ALL MAINTENANCES AT THE BELOW MUST BE IMPLEMENT IN TIME FOR THE GUARANTY VALIDITY.

MACHINE MAINTENANCE

*THE TANK SHOULD BE WASHED WITH CLEAN WATER AFTER EACH USE AND THE MACHINE WORKING METHOD USED TO CLEAR OUT. IN THIS WAY PUMP, HOSE AND WEAPON CAN BE CLEANED.

*FIRST CHANGE OF PUMP OIL MUST BE DONE AFTER 10 HOURS.

*SECOND CHANGE OF PUMP OIL MUST BE DONE AFTER 50 HOURS.

*THIRD CHANGE OF PUMP OIL MUST BE DONE AFTER 70 HOURS.

*ENGINE OIL SHOULD BE CHECKED EVERY 100 HOURS.

*AIR FILTER SHOULD BE CHECKED EVERY 100 HOURS.

*SPARK PLUG SHOULD BE CHECKED EVERY 50 HOURS.

*THE FELT OF PUMP COMPRESSION SHOULD BE CHECKED EVERY 50 HOURS.

*THE PUMP VALVES SHOULD BE CHECKED EVERY 100 HOURS.

EXCEPT AS AUTHORIZED SERVICE PERSON IF TRY TO REPAIR AND REMOVING THE MACHINE SPARE PARTS OR INSTALLING AFTERMARKET PURPOSE OR NON- USE OF MACHINE VOID THE GUARANTY EXCLUDES .

IF THE MAINTENANCES DOES NOT IMPLEMENT THEN THE MACHINE WILL NOT UNDER THE GU-ARANTY.

OIL CHANGING

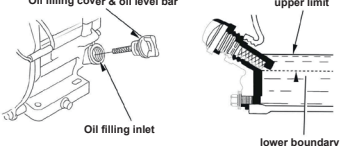

You should use no 20-50 motor oil inside motor

THE USED OIL SHOULD BE DRAINED WHILE THE ENGINE IS HOT.

Before each use you must control oil level

THE TANK SHOULD BE WASHED WITH CLEAN WATER AFTER EACH USE AND THE MACHINE WORKING METHOD USED TO CLEAR OUT. IN THIS WAY PUMP, HOSE AND WEAPON CAN BE CLEANED.

**CAUTION!**
BEFORE STARTING

Engine : 650 ml - No.10/40
Pump : 650 ml - No.30

FILL OIL !



Fill up the oil tank when the cursor comes half filling level position. 20-50 engine oil should be used in the pump. If the pesticide remains the tank after sprayin it will be harmful to the machine.

06

15

ENGINE	BARTECH GASOLINE ENGINE
Engine Type	single cylinder,4 stroke,air cooled,gasoline engine
Fuel / Fuel tank capacity lt	No.90 Unleaded fuel / 4.3
Seat inside dia. (mm)	68 * 45
Current density (cu.in)	196 (11.96)
Cycle (cycle/min.)	3600
Compression ratio	8.5 : 1
Power KW / HP	4.0 / 5.44
Max. Torque N.M. (r.p.m.)	11.0 / 2500
Oil quantity (lt) / Oil no / Type of using oil	0.6 / SAE10W30 / 4 stroke engine oil
First starting	Rope starter
Dimensions	385 x 335 x 350
Fuel consumption g/ s.s.	1.05
Spark plug	F6T
Weight (Kg)	16

GASOLINE ENGINE TECHNICAL SPECIFICATIONS

- * Please start the BARTECH GASOLINE ENGINE away from wall and 1 mtr away from other appliances.
- * In order to benefit fully from the BARTECH GASOLINE ENGINE, please use BARTECH GASOLINE ENGINE according to your needs.
- * Waste gases are poisonous and harmful to health. BARTECH gasoline engine must be started in ventilated areas.Waste gases must be goes out via a pipe.
- * Do not touch wet hands to the BARTECH gasoline engine when its working. Do not start it up under rain and snow. If needed to work it, please take caution.
- * Children and pets must be kept away while BARTECH gasoline engine is working
- * Do not touch hot parts such as driving engine and exhaust fitting.
- * Do not use generator at the areas where the materials can be flaming easily.
- If needed to work it, please take caution.
- * The ground must be steady and flat when the BARTECH gasoline engine will start.
- * Please learn how the Generator stops quickly for emergency situations.
- * Please stop the engine while input fuel into BARTECH gasoline engine and do not fill fuel in at the areas which has fire and spark.

GENERAL SAFETY INSTRUCTIONS

SAFETY INSTRUCTIONS

SAFETY INSTRUCTIONS

GENERAL SAFETY INSTRUCTIONS

- * Please start the BARTECH GASOLINE ENGINE away from wall and 1 mtr away from other appliances.
- * Please do necessary controls not to cause any accident and damage to your unit
- * In order to benefit fully from the BARTECH GASOLINE ENGINE, please use BARTECH GASOLINE ENGINE according to your needs.
- * Waste gases are poisonous and harmful to health. BARTECH gasoline engine must be started in ventilated areas.Waste gases must be goes out via a pipe.
- * Do not touch wet hands to the BARTECH gasoline engine when its working. Do not start it up under rain and snow. If needed to work it, please take caution.
- * Children and pets must be kept away while BARTECH gasoline engine is working
- * Do not touch hot parts such as driving engine and exhaust fitting.
- * Do not use generator at the areas where the materials can be flaming easily.
- If needed to work it, please take caution.
- * The ground must be steady and flat when the BARTECH gasoline engine will start.
- * Please learn how the Generator stops quickly for emergency situations.
- * Please stop the engine while input fuel into BARTECH gasoline engine and do not fill fuel in at the areas which has fire and spark.

GASOLINE ENGINE TECHNICAL SPECIFICATIONS

ENGINE	BARTECH GASOLINE ENGINE
Engine Type	single cylinder,4 stroke,air cooled,gasoline engine
Fuel / Fuel tank capacity lt	No.90 Unleaded fuel / 4.3
Seat inside dia. (mm)	68 * 45
Current density (cu.in)	196 (11.96)
Cycle (cycle/min.)	3600
Compression ratio	8.5 : 1
Power KW / HP	4.0 / 5.44
Max. Torque N.M. (r.p.m.)	11.0 / 2500
Oil quantity (lt) / Oil no / Type of using oil	0.6 / SAE10W30 / 4 stroke engine oil
First starting	Rope starter
Dimensions	385 x 335 x 350
Fuel consumption g/ s.s.	1.05
Spark plug	F6T
Weight (Kg)	16

15

90



Fill up the oil tank when the cursor comes half filling level position. 20-50 engine oil should be used in the pump. If the pesticide remains the tank after sprayin it will be harmful to the machine.

**CAUTION!**
BEFORE STARTING

Engine : 650 ml - No.10/40
Pump : 650 ml - No.30

FILL OIL !

MACHINE MAINTENANCE

*THE TANK SHOULD BE WASHED WITH CLEAN WATER AFTER EACH USE AND THE MACHINE WORKING METHOD USED TO CLEAR OUT. IN THIS WAY PUMP, HOSE AND WEAPON CAN BE CLEANED.

*FIRST CHANGE OF PUMP OIL MUST BE DONE AFTER 10 HOURS.

*SECOND CHANGE OF PUMP OIL MUST BE DONE AFTER 50 HOURS.

*THIRD CHANGE OF PUMP OIL MUST BE DONE AFTER 70 HOURS.

*ENGINE OIL SHOULD BE CHECKED EVERY 100 HOURS.

*AIR FILTER SHOULD BE CHECKED EVERY 100 HOURS.

*SPARK PLUG SHOULD BE CHECKED EVERY 50 HOURS.

*THE FELT OF PUMP COMPRESSION SHOULD BE CHECKED EVERY 50 HOURS.

*THE PUMP VALVES SHOULD BE CHECKED EVERY 100 HOURS.

EXCEPT AS AUTHORIZED SERVICE PERSON IF TRY TO REPAIR AND REMOVING THE MACHINE SPARE PARTS OR INSTALLING AFTERMARKET PURPOSE OR NON- USE OF MACHINE VOID THE GUARANTY EXCLUDES .

IF THE MAINTENANCES DOES NOT IMPLEMENT THEN THE MACHINE WILL NOT UNDER THE GU-ARANTY.

OIL CHANGING

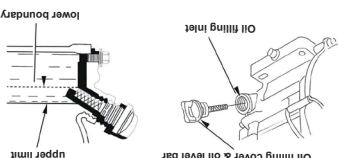

You should use no 20-50 motor oil inside motor

THE USED OIL SHOULD BE DRAINED WHILE THE ENGINE IS HOT.

Before each use you must control oil level

THE TANK SHOULD BE WASHED WITH CLEAN WATER AFTER EACH USE AND THE MACHINE WORKING METHOD USED TO CLEAR OUT. IN THIS WAY PUMP, HOSE AND WEAPON CAN BE CLEANED.

ALL MAINTENANCES AT THE BELOW MUST BE IMPLEMENT IN TIME FOR THE GUARANTY VALIDITY.

THINGS TO DO CROP PROCESSING & ENDING

USING GASOLINE ENGINE

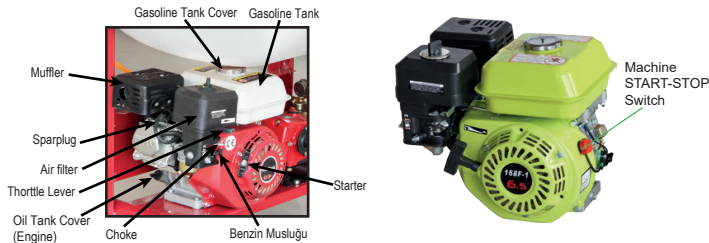

CAUTION !

Please read this USER MANUAL carefully before using BARTECH GASOLINE ENGINE to prevent any damages because of wrong usage or any causing accident and please follow using instructions. Pay attention to the informations and warnings on BARTECH GASOLINE ENGINE. It is forbidden to make any modification and to change revolution cycles which had been set by manufacturer on BARTECH GASOLINE ENGINE. In case to do contrary, product will be OUT OF WARRANTY.

STANDARD FEATURES

OIL WARNING SYSTEM

Engine does not work if the oil quantity is less than requested level. In case of drop down of level during working, engine stops automatically in order to prevent further damages.

AUTOMATIC DECOMPRESSION SYSTEM

BARTECH series gasoline engine ensures advantage to users by working of automatically decompression system without power needed.

AIR CLEANING SYSTEM

High performance oily air filter is suitable to changeable environment conditions by itself structure. Because of it has OIL BATHING special air filter, the engine works long time even if extremely dusty places.

14

07

MALFUNCTION AND MAINTENANCE INSTRUCTIONS

Please stop the machine in order to mame periodic maintenance.

- Load off the machine 15 minutes in every 1 hour while it is working.
- Check the screws periodically once a month. tighten the loosen screws.
- Do not clean your machine with wet something in order to make your machine long life against to corrosion.
- Keep it store between -50°C and +40°C temperatures.

USE & MAINTENANCE INSTRUCTIONS

1. Don't start sprayer without water inside of spraying tank
2. Before starting sprayer please be sure sprayer gun and valifes on position
3. Use clear water to long life of pump
4. To keep freeze in winter time, please be sure keep your products without water inside of gun and spraying hoses
5. Check engine and pump oil every month.
6. Buy your product spare parts from our factory or authorized our dealer
7. Our all products have 2 year warranty to production mistakes

WHILE MOVING AND TRANSPORTATION !

- Please get fasten up mobile parts of machine whjle doing transportation process.

AIR CLEANING SYSTEM

High performance oily air filter is suitable to changeable environment conditions by itself structure. Because of it has OIL BATHING special air filter, the engine works long time even if extremely dusty places.

AUTOMATIC DECOMPRESSION SYSTEM

BARTECH series gasoline engine ensures advantage to users by working of automatically decompression system without power needed.

OIL WARNING SYSTEM

Engine does not work if the oil quantity is less than requested level. In case of drop down of level during working, engine stops automatically in order to prevent further damages.

STANDARD FEATURES

Please read this USER MANUAL carefully before using BARTECH GASOLINE ENGINE to prevent any damages because of wrong usage or any causing accident and please follow using instructions. Pay attention to the informations and warnings on BARTECH GASOLINE ENGINE. It is forbidden to make any modification and to change revolution cycles which had been set by manufacturer on BARTECH GASOLINE ENGINE. In case to do contrary, product will be OUT OF WARRANTY.

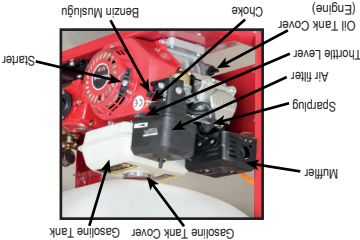

USING GASOLINE ENGINE

MALFUNCTION AND MAINTENANCE INSTRUCTIONS

Please stop the machine in order to mame periodic maintenance.

- Load off the machine 15 minutes in every 1 hour while it is working.
- Check the screws periodically once a month. tighten the loosen screws.
- Do not clean your machine with wet something in order to make your machine long life against to corrosion.
- Keep it store between -50°C and +40°C temperatures.

USE & MAINTENANCE INSTRUCTIONS

1. Don't start sprayer without water inside of spraying tank
2. Before starting sprayer please be sure sprayer gun and valifes on position inside of gun and spraying hoses
3. Use clear water to long life of pump
4. To keep freeze in winter time, please be sure keep your products without water inside of gun and spraying hoses
5. Check engine and pump oil every month.
6. Buy your product spare parts from our factory or authorized our dealer
7. Our all products have 2 year warranty to production mistakes

WHILE MOVING AND TRANSPORTATION !

- Please get fasten up mobile parts of machine whjle doing transportation process.

SPRAYER PM200 - Technical Specifications

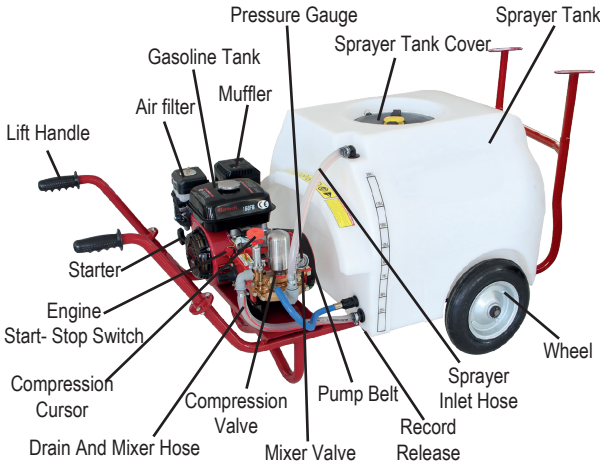

MODEL	PM200	PM100
Engine Capacity	196 cc	196 cc
Engine Power	6,5 Hp	6,5 Hp
Engine Type	4 Stroke,	4 Stroke,
Speed	3600 rpm/min	3600 rpm/min
Fuel Tank Capacity	3,6 L	3,6 L
Sprayer Tank Capacity	200 L (Polythene)	100 L (Polythene)
Pump Type	22 L/Max.	22 L/Max.
Pump Power / Bar	1,5 ~ 2 Hp (Max.40 Bar)	1,5 ~ 2 Hp (Max.40 Bar)
Pump Speed	800 ~ 1200 s/min	800 ~ 1200 s/min
Suction	13 ~ 22 L/min	13 ~ 22 L/min
Pressure	10 ~ 40 kgf/cm ³	10 ~ 40 kgf/cm ³
Max. Spraying Distance	8 - 10 m	8 - 10 m
Hose Reel	Optional	Optional
Weight	60 Kg	52 Kg
Dimensions (WXLXH)	81 x 125 x 75 cm	81 x 117 x 60 cm

08

13

PART LIST

01	Crank case	36	Grease cup	71	Plain washer
02	Oil inlet cover	37	Cylinder	72	Pressure adjuster
03	Name plate	38	Set clip for adjusting	73	Hex bolt
04	Plunger	39	Valve assembly	74	Plain washer
05	Plunger pin	40	Spring box	75	Packing holder
06	Connecting rod	41	Valve spring	76	Spindle packing
07	Bolt, connecting rod	42	Stopper	77	Box, oil seal
08	Spring washer	43	Valve seat	78	Spindle
09	Plain washer	44	Valve seal	79	Spindle cap
10	Cover, crank case	45	Suction chamber	80	Ball valve
11	Packing, cover	46	Stud bolt	81	Body, over flow
12	Screw, cover	47	Plain washer	82	Valve seat
13	Oil gauge	48	Spring washer	83	Packing, valve seat
14	Drain plug	49	Hex nut	84	Flange
15	Packing drain plug	50	Suction cap	85	Lock nut
16	Crank shaft	51	Water outler chamber	86	V-pulley
17	Ball bearing	52	Stud bolt	87	Key
18	Case ball bearing	53	Plain washer	88	Plain washer
19	Oil seal, crank shaft	54	Hex nut	89	Spring washer
20	Packing, bearing case	55	Air chamber	90	Hex bolt
21	Hex bolt	56	Pressure gauge	91	Strainer joint
22	Cover, crank shaft	57	Cock (valve)	92	Suction hose
23	Screw, crank cover	58	Outlet plug	93	Wing nut, suction
24	Plain washer	59	Pressure adjusting screw	94	Male joint
25	Gland cover	60	Fly nut	95	Suction, packing
26	Plain washer	61	Spring box	96	Strainer, suction assembly
27	Spring washer	62	Cross screw	97	Over flow hose
28	Stud bolt	63	Plain washer	98	Wing nut, over flow
29	Plunger oil seal	64	Spring washer	99	Male joint
30	Check ring	65	Level	100	Over flow packing
31	Adjusting ring	66	Upper metal	101	Bed, crank case
32	Grease seal	67	Regulation spring	102	Spring washer
33	Grease ring	68	Spring seat	103	Hex bolt
34	V.packing	69	Pin	104	Adjusting handle
35	V.packing seat	70	E-ring		

13

08

01	Crank case	36	Grease cup	71	Plain washer
02	Oil inlet cover	37	Cylinder	72	Pressure adjuster
03	Name plate	38	Set clip for adjusting	73	Hex bolt
04	Plunger	39	Valve assembly	74	Plain washer
05	Plunger pin	40	Spring box	75	Packing holder
06	Connecting rod	41	Valve spring	76	Spindle packing
07	Bolt, connecting rod	42	Stopper	77	Box, oil seal
08	Spring washer	43	Valve seat	78	Spindle
09	Plain washer	44	Valve seal	79	Spindle cap
10	Cover, crank case	45	Suction chamber	80	Ball valve
11	Packing, cover	46	Stud bolt	81	Body, over flow
12	Screw, cover	47	Plain washer	82	Valve seat
13	Oil gauge	48	Spring washer	83	Packing, valve seat
14	Drain plug	49	Hex nut	84	Flange
15	Packing drain plug	50	Suction cap	85	Lock nut
16	Crank shaft	51	Water outler chamber	86	V-pulley
17	Ball bearing	52	Stud bolt	87	Key
18	Case ball bearing	53	Plain washer	88	Plain washer
19	Oil seal, crank shaft	54	Hex nut	89	Spring washer
20	Packing, bearing case	55	Air chamber	90	Hex bolt
21	Hex bolt	56	Pressure gauge	91	Strainer joint
22	Cover, crank shaft	57	Cock (valve)	92	Suction hose
23	Screw, crank cover	58	Outlet plug	93	Wing nut, suction
24	Plain washer	59	Pressure adjusting screw	94	Male joint
25	Gland cover	60	Fly nut	95	Suction, packing
26	Plain washer	61	Spring box	96	Strainer, suction assembly
27	Spring washer	62	Cross screw	97	Over flow hose
28	Stud bolt	63	Plain washer	98	Wing nut, over flow
29	Plunger oil seal	64	Spring washer	99	Male joint
30	Check ring	65	Level	100	Over flow packing
31	Adjusting ring	66	Upper metal	101	Bed, crank case
32	Grease seal	67	Regulation spring	102	Spring washer
33	Grease ring	68	Spring seat	103	Hex bolt
34	V.packing	69	Pin	104	Adjusting handle
35	V.packing seat	70	E-ring		

PART LIST

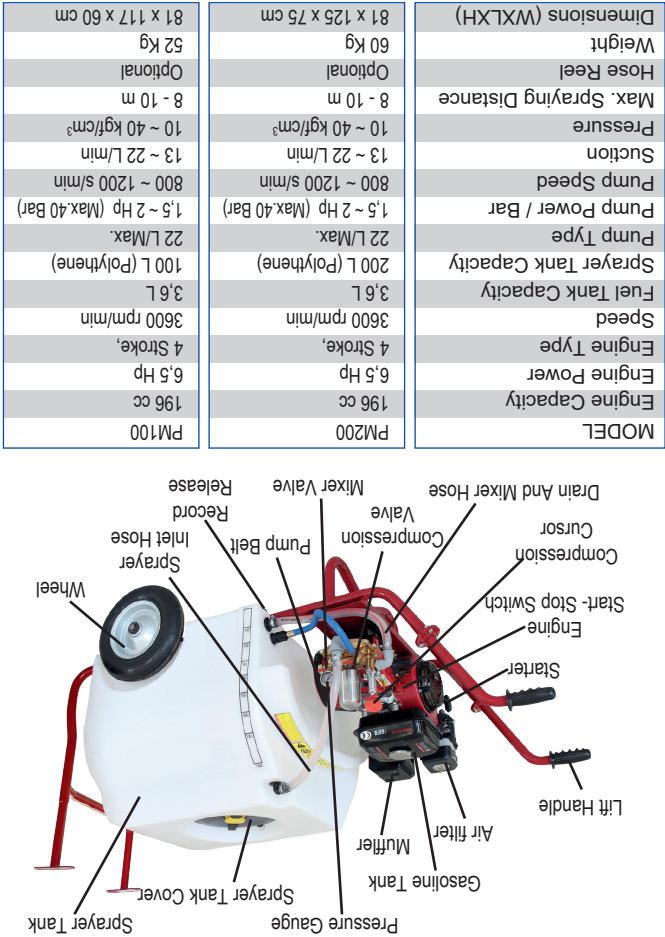

SPRAYER PM200 - Technical Specifications

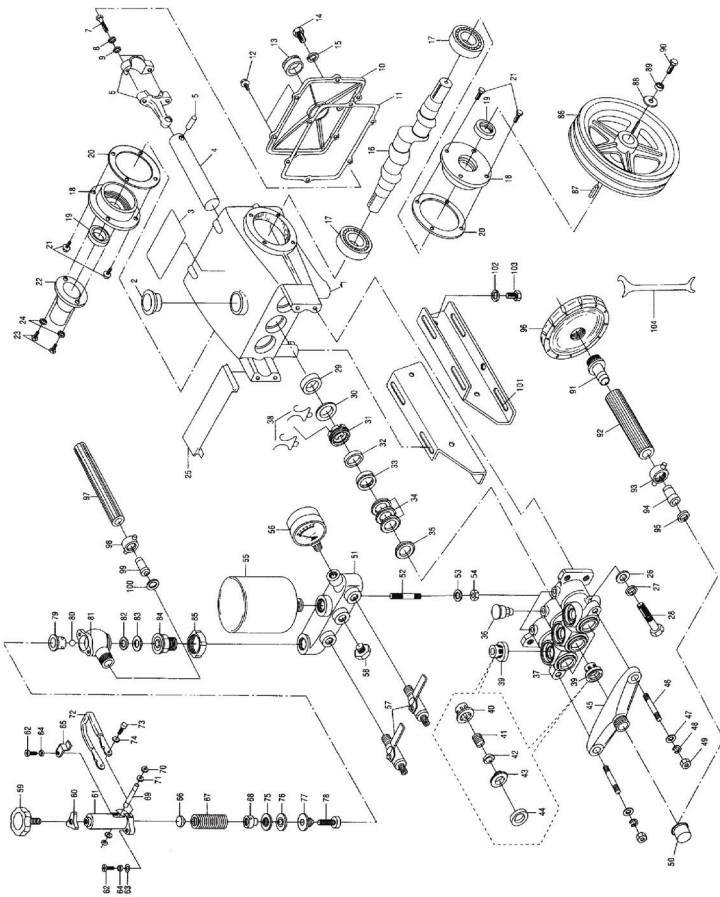

12

6

- Attention!
- To keep the sprayer perfect in performance, please follow the instruction printed in this page.
- A. Operation Instruction
1. Check every fastener and make sure that the sprayer and the motor are installed firmly on the frame.
 2. Set the two pulleys in a straight line, and the belt in an appropriate tightness.
 3. Every joint of the hoses must be tightened to prevent from leaking.
 4. Before starting the motor, shut off the (57) Cock (Valve) , loose the (59) Pressure Adjusting Screw and pull the (72) Pressure Adjuster to the top.
 5. Start the motor to power the sprayer, keep a proper revolution. Press the (72) Pressure Adjuster to the bottom. Keep the pressure around 21-35Kgs. By adjusting the (59) Pressure Adjusting Screw.
 6. Open the (57) Cock (Valve) to start spraying.
 7. After the spraying is over, pull the (72) Pressure Adjuster to the top and operate the sprayer with fresh water to clean out the remaining chemicals.
- B. Pump Lubrication
1. Replace the engine oil after the sprayer has been used for the first 10 hours, 50 hours, and thence every 70 hours.
 2. Drain away the dirty engine oil by screwing off the (14) Drain Plug.
 3. After the (14) Drain Plug is screwed on, remove the (2) oil Inlet Cover and refill #30-40 clean engine oil.
 4. Keep the oil level at 2 / 3 of the (13) oil Gauge.
 5. Always fill the (36) Grease Cups with grease. Screw on the (36) Grease Cups 2-3 cycles every 2 hours of spraying.
- C. Trouble Shooting
- a. Feeding Failure & Pressure Instability
1. Check whether the (92) Suction Hose is leaking or is stuck.
 2. Open the (57) Cock (valve) to release the surplus air.
 3. Remove the (45) Suction Chamber and the (51) Water Outlet Chamber check if the (39) Valve Assembly are stuck or damaged.
- b. Pressure Insufficiency
1. Check whether the pressure has been adjusted properly.
(refer to the operation instruction No. 5)
 2. Check whether the belt is too loose.
 3. Check whether the Spray Hose and the couplings are broken and damaged.
- c. Cylinder Leakage.
1. Remove the (25) Gland cover and wind up the (31) Adjusting Rings.
 2. If still in vain, replace the (34) V-packings in the (37) Cylinder.
- Remark: () indicates the " part number " of relative part.

Attention!

To keep the sprayer perfect in performance, please follow the instruction printed in this page.

A. Operation Instruction

1. Check every fastener and make sure that the sprayer and the motor are installed firmly on the frame.
2. Set the two pulleys in a straight line, and the belt in an appropriate tightness.
3. Every joint of the hoses must be tightened to prevent from leaking.
4. Before starting the motor, shut off the (57) Cock (Valve) , loose the (59) Pressure Adjusting Screw and pull the (72) Pressure Adjuster to the top.
5. Start the motor to power the sprayer, keep a proper revolution. Press the (72) Pressure Adjuster to the bottom. Keep the pressure around 21-35Kgs. By adjusting the (59) Pressure Adjusting Screw.
6. Open the (57) Cock (Valve) to start spraying.
7. After the spraying is over, pull the (72) Pressure Adjuster to the top and operate the sprayer with fresh water to clean out the remaining chemicals.

B. Pump Lubrication

1. Replace the engine oil after the sprayer has been used for the first 10 hours, 50 hours, and thence every 70 hours.
2. Drain away the dirty engine oil by screwing off the (14) Drain Plug.
3. After the (14) Drain Plug is screwed on, remove the (2) oil Inlet Cover and refill #30-40 clean engine oil.
4. Keep the oil level at 2 / 3 of the (13) oil Gauge.
5. Always fill the (36) Grease Cups with grease. Screw on the (36) Grease Cups 2-3 cycles every 2 hours of spraying.

C. Trouble Shooting

a. Feeding Failure & Pressure Instability

1. Check whether the (92) Suction Hose is leaking or is stuck.
2. Open the (57) Cock (valve) to release the surplus air.
3. Remove the (45) Suction Chamber and the (51) Water Outlet Chamber check if the (39) Valve Assembly are stuck or damaged.

b. Pressure Insufficiency

1. Check whether the pressure has been adjusted properly.
(refer to the operation instruction No. 5)
2. Check whether the belt is too loose.
3. Check whether the Spray Hose and the couplings are broken and damaged.

c. Cylinder Leakage.

1. Remove the (25) Gland cover and wind up the (31) Adjusting Rings.
2. If still in vain, replace the (34) V-packings in the (37) Cylinder.

Remark: () indicates the " part number " of relative part.

9

12

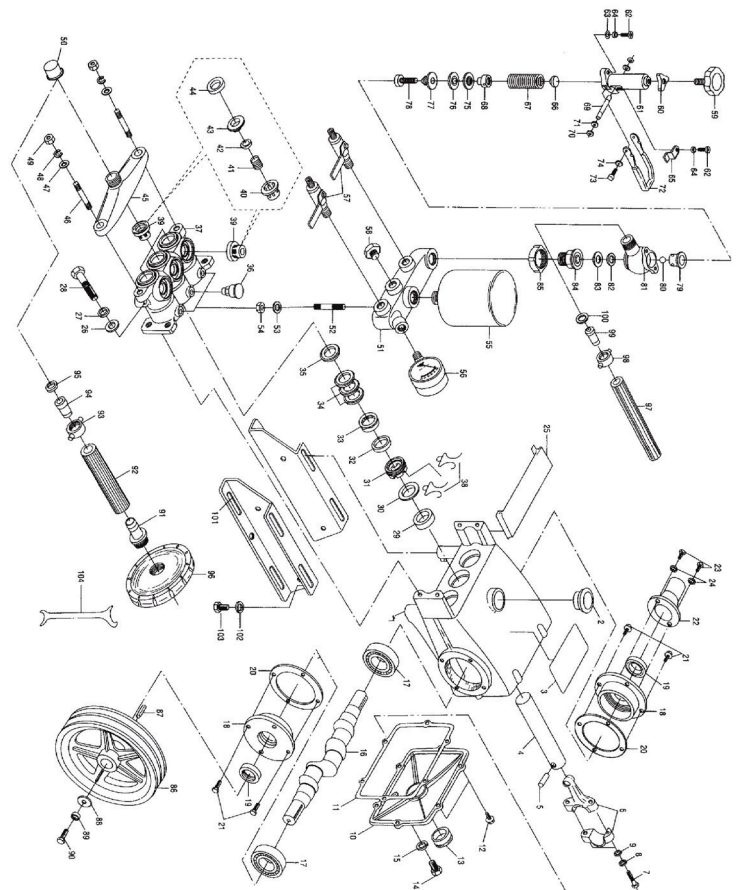

USING PUMP

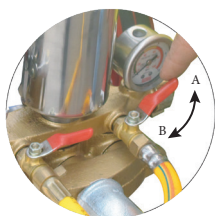

Run the engine. (How to run gasoline engine is in the other pages.)

Turn the mixer valve of pump from **A** position to **B** position. In this way the chemicals will be mixed in the pesticide tank.

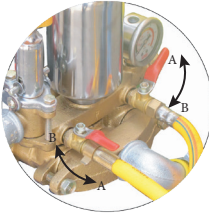

Turn the hose valve to **A** position for the prepare to disinfect. (The valve will be off on the **B** position.)

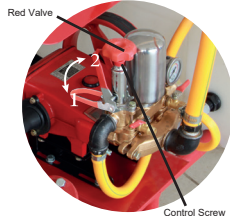

Turn the compression switch to **2** position for the compression transfer to hose valve. (Optimum compression is 25 BAR.

Compression setting is fixable with the black plastic screw on the regulator. Pull on the yellow control screw on the bottom after the compression setting.

Do not operate without put water rinside Tank.

Pay attention that valves and sprayer guns should be switch ON before starting.

Spraying pressure valve, mixing valve and pressure lever turns to close position before starting. The machine works by pushing black button after proper electric socket and adjust pressure level till coming to 4 level on the green closed pressure indicator from pressure gauging regulator. After that start to operating by opening of valves by providing chemical and water mixture.



If the pressure is on these levels, operating makes harmful to your pump.

10

11

PUMP TECHICAL SPECIFICATION	
Model	B-22JPD
Power	1,5~2 Hp
Speed	800 ~ 1200 rpm/min
Emme	14 ~ 22 L/min
Pressure	10 ~ 40 Kg/cm ²
Weight	8,5 kg

PUMP DEFINITION

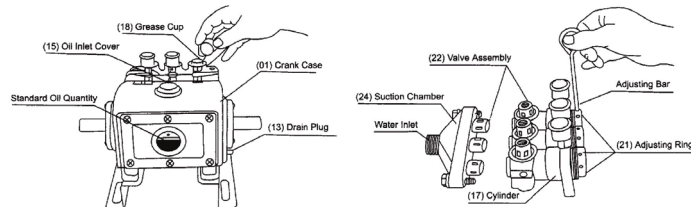
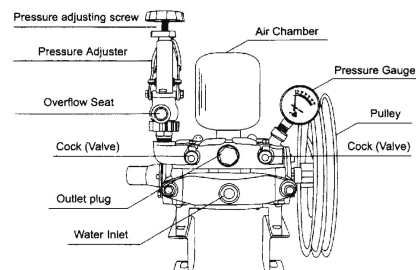

PUMP TECHICAL SPECIFICATION

Model	B-22JPD
Power	1,5~2 Hp
Speed	800 ~ 1200 rpm/min
Emme	14 ~ 22 L/min
Pressure	10 ~ 40 Kg/cm ²
Weight	8,5 kg

11

10



If the pressure is on these levels, operating makes harmful to your pump.



Spraying pressure valve, mixing valve and pressure lever turns to close position before starting. The machine works by pushing black button after proper electric socket and adjust pressure level till coming to 4 level on the green closed pressure indicator from pressure gauging regulator. After that start to operating by opening of valves by providing chemical and water mixture.

Do not operate without put water rinside Tank.
Pay attention that valves and sprayer guns should be switch ON before starting.

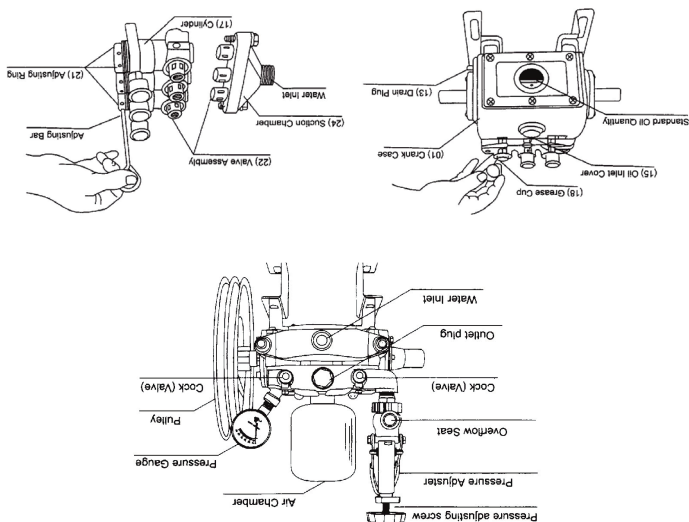

Turn the compression switch to **2** position for the compression transfer to hose valve. (Optimum compression is 25 BAR. Compression setting is fixable with the black plastic screw on the regulator. Pull on the yellow control screw on the bottom after the compression setting.

Turn the hose valve to **A** position for the prepare to disinfect. (The valve will be off on the **B** position.)

Run the engine. (How to run gasoline engine is in the other pages.)
Turn the mixer valve of pump from **A** position to **B** position. In this way the chemicals will be mixed in the pesticide tank.

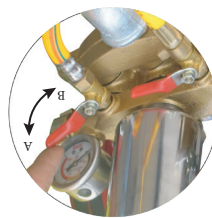
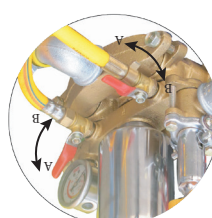

USING PUMP

PUMP DEFINITION